



# 26-05 ASTORIA BLVD.

ASTORIA, NY

VENTED SPACE WITH USABLE LOWER LEVEL

## PROPERTY DESCRIPTION:

**Size:** Corner

Ground Floor: 4,364 SF

Usable Lower Level: 4,796 SF

**Possession:** Immediate

**Use:** All Considered (Vented with HVAC)

**Cieling:** 18+

**Frontage:** 82' - 92'

## HIGHLIGHTS:

- Two (2) blocks from **N** **Q** Train Stations
- Around the corner from Mt. Sinai Hospital
- Short walking distance to Astoria Park
- 30 units in the building with TCO in place
- Back access for deliveries
- **Usable lower level**
- **Cooking + HVAC**

## SOME OF OUR NEIGHBORS:



For further information please contact:

Nicole Liebman

212.579.7000 ext. 117

nl@hudsonre.com



25 E 21 ST, 9 FL NY, NY 10010

212.579.7000

www.hudsonre.com

# 26-05 ASTORIA BLVD.

ASTORIA, NY

SITE PLAN

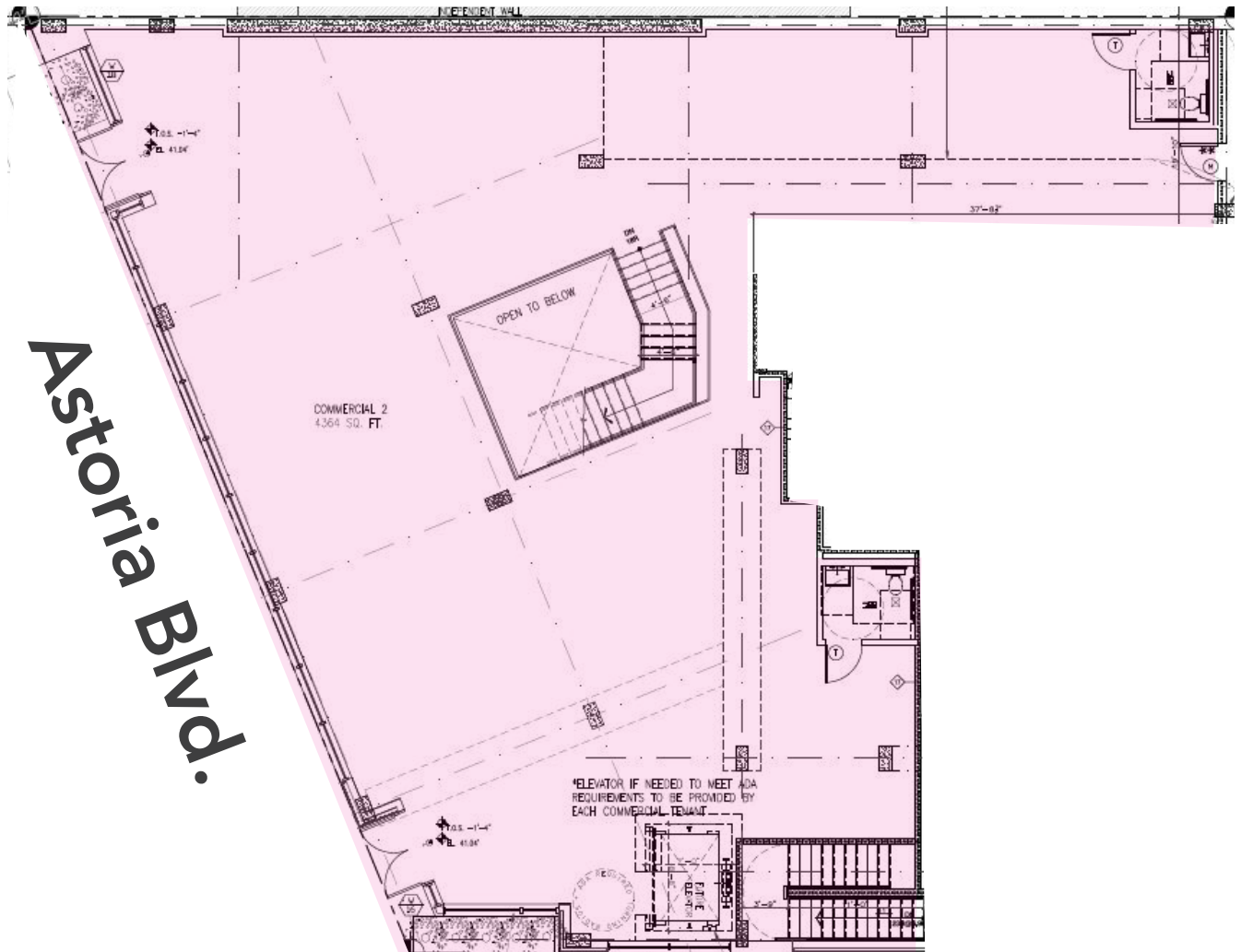

## 28th St.

For further information please contact:

Nicole Liebman

212.579.7000 ext. 117

nl@hudsonre.com

 HUDSON

25 E 21 ST, 9 FL NY, NY 10010

212.579.7000

www.hudsonre.com

# 26-05 ASTORIA BLVD.

ASTORIA, NY

MAP



For further information please contact:  
Nicole Liebman  
212.579.7000 ext. 117  
nl@hudsonre.com

**HUDSON**

25 E 21 ST, 9 FL NY, NY 10010  
212.579.7000  
www.hudsonre.com