



ONE RETAIL SPACE AVAILABLE AT THE 1 HOTEL

90 FURMAN STREET

BROOKLYN, NY

LOCAL TRANSPORTATION:     

PROPERTY DESCRIPTION:

RETAIL SPACE 1: AVAILABLE

Size: 903 SF

Frontage: 63'-9"

Ceiling Height: 14'-4"

Possession: Immediate

RETAIL SPACE 2: **LEASED**

Size: 1,259 SF



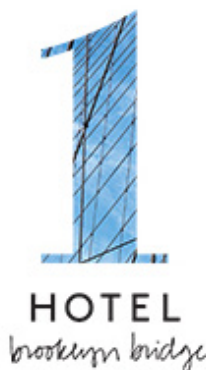

Frontage: 23'-5"

Ceiling Height: 14'-4"

Possession: Immediate



HIGHLIGHTS:

- At the base (luxury building with 106 condominium residences) the new 1 Hotel Brooklyn Bridge with 194-rooms
- Located within Brooklyn Bridge Park
- Multiple subway lines within walking distance, and steps from East River ferry to Manhattan     
- Built-in traffic from Pierhouse residents, guests of 1 Hotel Brooklyn Bridge, and visitors of Brooklyn Bridge Park

For further information please contact:

Nicole Liebman

212.579.7000 ext. 117

nl@hudsonre.com

Chris Havens

chavens@terrarcg.com



25 E 21 ST, 9 FL NY, NY 10010

212.579.7000

www.hudsonre.com

90 FURMAN STREET

BROOKLYN, NY

Retail Space 1 | 903 square feet

- Frontage: 63'-9" along Furman Street
- Unfinished ceiling height of 14'-4"



Retail Space 2 | 1,259 square feet

- Frontage: 60'-8" along Furman Street, 23'-5" along pass-through
- Unfinished ceiling height of 14'-4"

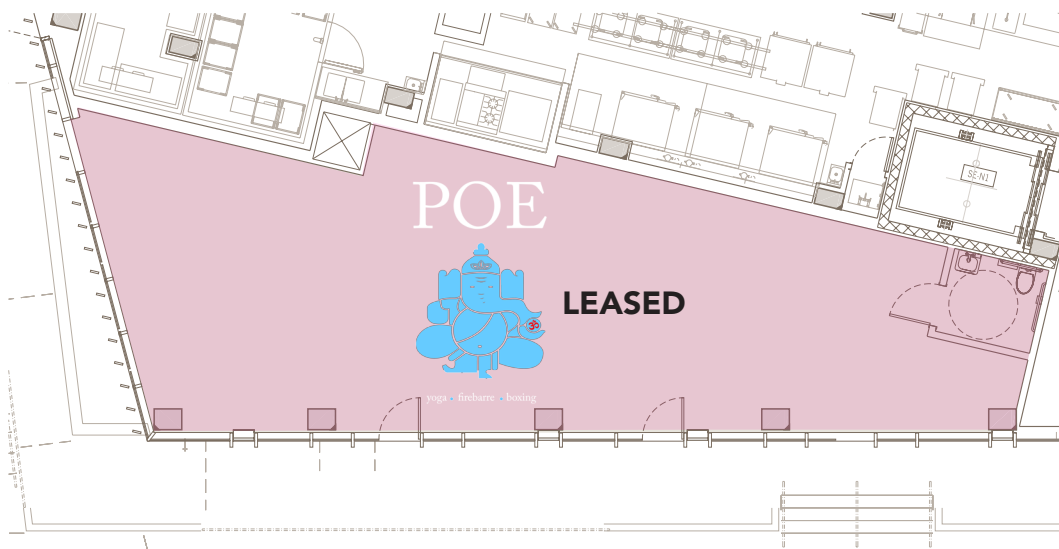

For further information please contact:

Nicole Liebman
212.579.7000 ext. 117
nl@hudsonre.com

Chris Havens
chavens@terraccrg.com



25 E 21 ST, 9 FL NY, NY 10010
212.579.7000
www.hudsonre.com

90 FURMAN STREET

BROOKLYN, NY



 = Residential/Commercial Developments

90
Furman Street

East River Ferry &
NY Water Taxi

Brooklyn
Bridge Park

Cadman
Plaza Park

Downtown
Brooklyn

For further information please contact:

Nicole Liebman
212.579.7000 ext. 117
nl@hudsonre.com

Chris Havens
chavens@terrarcg.com

 **HUDSON**

25 E 21 ST, 9 FL NY, NY 10010
212.579.7000
www.hudsonre.com